

RR1-5 INSTRUCTIONS

■ PARTS INCLUDED :

1. LR41 Battery
2. M4 Screw
3. The upper cover
4. LED
5. Bottom cover
6. M4 Nut

■ TOOLS NEEDED :

- 7mm Wrench
- Screw Driver

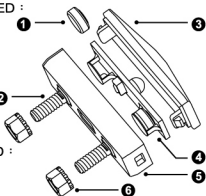

1 WARNING LIGHT INSTALLATION

Place the LED reflector into the pedal body where the reflector location.

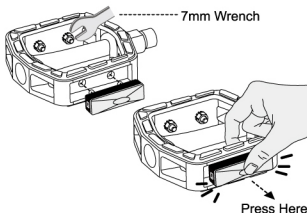

- There are two different signa
- The normal signal could be lasted for **13 hours** and the "flash" signal will be **25 hours**.

2 OPERATION TO CHANGE THE BATTERY

- 1 Press the connection point
- 2 Push the battery move out
- 3 Place LR41 battery
- 4 Have one side of the transparant cover insert back to the connection point.
- 5 Press down the transparent cover to close it.

RR1-5 說明書

■ 包含的零件：

1. LR41 水銀電池
2. M4 固定螺絲
3. 透明上蓋
4. LED 板
5. 下蓋
6. M4 螺帽

■ 使用工具：

- 7mm 開口扳手
- 一字起子

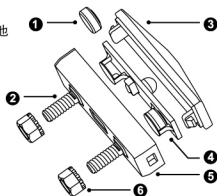

1 警示燈安裝說明

將警示燈置入踏板兩側反光片孔，使用7mm開口扳手鎖緊螺帽

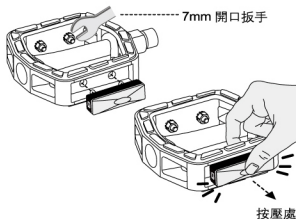

- 具備"持光"及"閃爍"兩種燈號模式
- 持續持光可達**13小時**/閃爍發光可達**25小時**

2 電池更換操作說明

- 1 壓入結合點
- 2 將電池推出
- 3 置入LR41 水銀電池
- 4 先將透明上蓋一方扣入結合點
- 5 將透明上蓋另一方下壓扣入結合點